

Test Leads

AL-39H

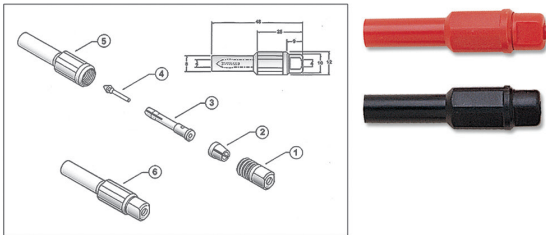

- Stacking-shrouded plug.
AL-39HR Red
AL-39HB Black

AL-42, AL-42S



- Terminal : 4mm banana plug
- AL-42 wire : PVC UL1803
- AL-42S wire : silicon UL3239
- Length : 1500mm ± 30mm.
- Rating :
EN 61010-031:2002 + A1:2008 CAT IV 600V 10A /
CAT III 1kV 10A

AL-4WER



- **For earth tester (Four wires).**
- **Terminal** : 4mm brass banana plug.
- **Wire** : PVC
Out dimension : 3.5mm
Braid copper wires : 0.127 / 65mm
Length : Black-3m Blue-20m Red-36m Green-50m
- **Auxiliary earth spikes** : 45cm
- For 4-wire earth resistance tester use

AL-50

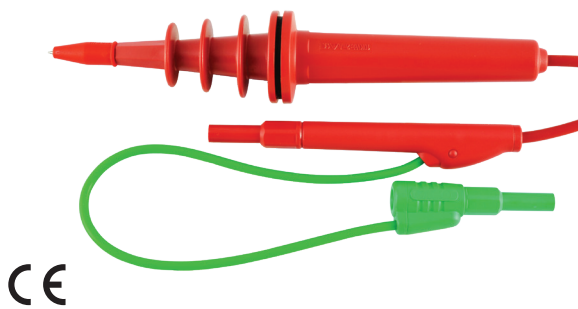

- Large test probe handle with shrouded 4mm brass caged banana plug tip
- Super insulated silicone wire, 2.7m
Outside diameter: 6.5mm
- Safety straight input plug connect with extra green guard
- ⚠ **WARNING:**
INPUT: MAX. AC 1000V
OUTPUT: MAX. DC 10kV. 3W
ONLY AVAILABLE FOR INSULATION TESTER
- Rating:
EN 61010-031:2015 CAT III 10kVdc 2mA

AL-51



- **Terminal** : 4mm banana plug
- **Wire** : PVC UL1803
Temperature tolerance range -40°C ~ 105°C
Out dimension : 4mm
Braid copper wires (180 of 0.12mm)
Length : 1100±30mm
- Rating : EN 61010-031:2002 CAT IV 1000V 15A

